

**PLAN FOR PROPOSED G+III STORIED RESIDENTIAL BUILDING PLAN AT
 MOUZA-SRIPUR BAGHARGHOLE, J.L. NO.-59, R.S. DAG NO.-391(P), &
 392(P), L.O.P. NO.-1543, HOLDING NO.-24, SUKANTA PALLY & SRI
 KRISHNA PALLY , WARD NO.-32, UNDER- RAJPUR SONARPUR
 MUNICIPALITY, DIST- 24 PGS.(SOUTH), P.S.- SONARPUR, NARENDRAPUR
 (NEW), ASSESSMENT NO.1104302049149**

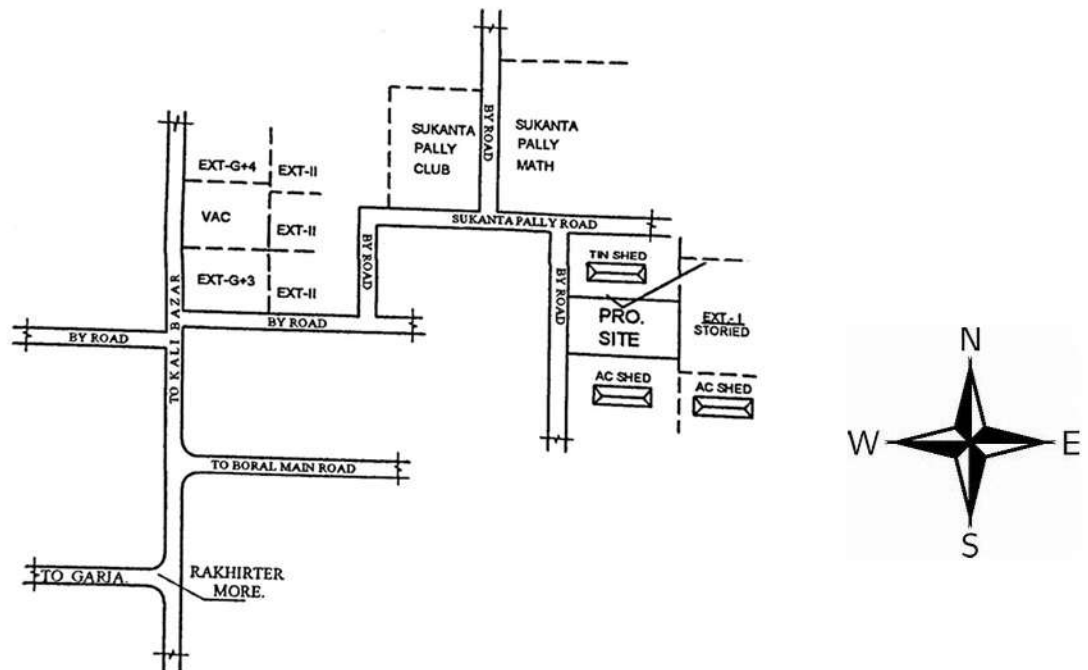

LOCATION PLAN

SCALE :- 1 : 4000

Co - ordinate in WGS 84 and site elevation (AMSL)

Reference points marked in the site plan of the proposal	Co - ordinate in WGS84		Site elevation (AMSL)
	Latitude	Longitude	
A"	22° 29' 58.99" N	88° 18' 16.39" E	4.98 Mts.
	22° 29' 59.64" N	88° 18' 16.54" E	
	22° 29' 58.96" N	88° 18' 16.71" E	
	22° 29' 59.58" N	88° 18' 16.86" E	

Krishnendu Ray

KRISHNENDU RAY
 LBS OF K.M.C.
 LBS No.: 1085, CLASS-I